

# PROPOSED FLOOR PLAN

## KIDS WEAR - PAVILION 1, 2 & 3 ( GROUND LEVEL)

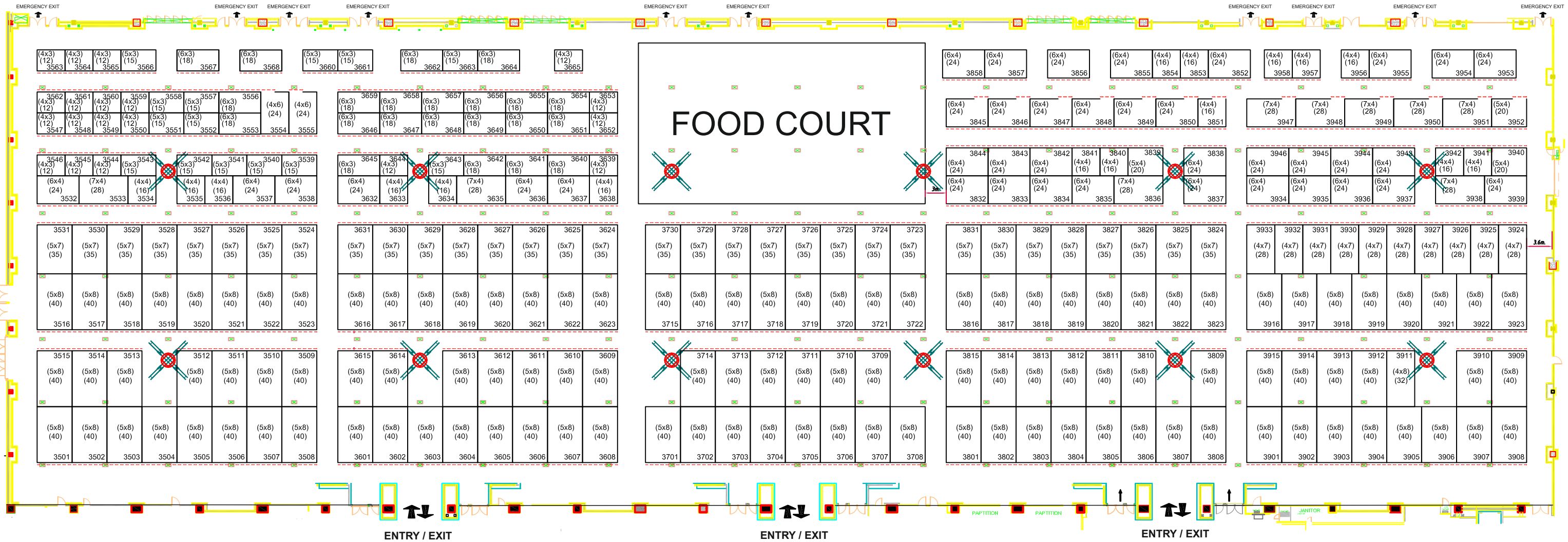

--- INDICATING OPEN SIDE OF STALL

Though due care has been taken in preparing the Floor Plan. CMAI reserves the right to alter, vary, enlarge, reduce the Floor Plan as may be required from time to time. However, abundant care would be exercised to ensure that the Participants are not in anyway inconvenienced.

# PROPOSED FLOOR PLAN KIDS WEAR - JASMINE HALL (LEVEL-3)

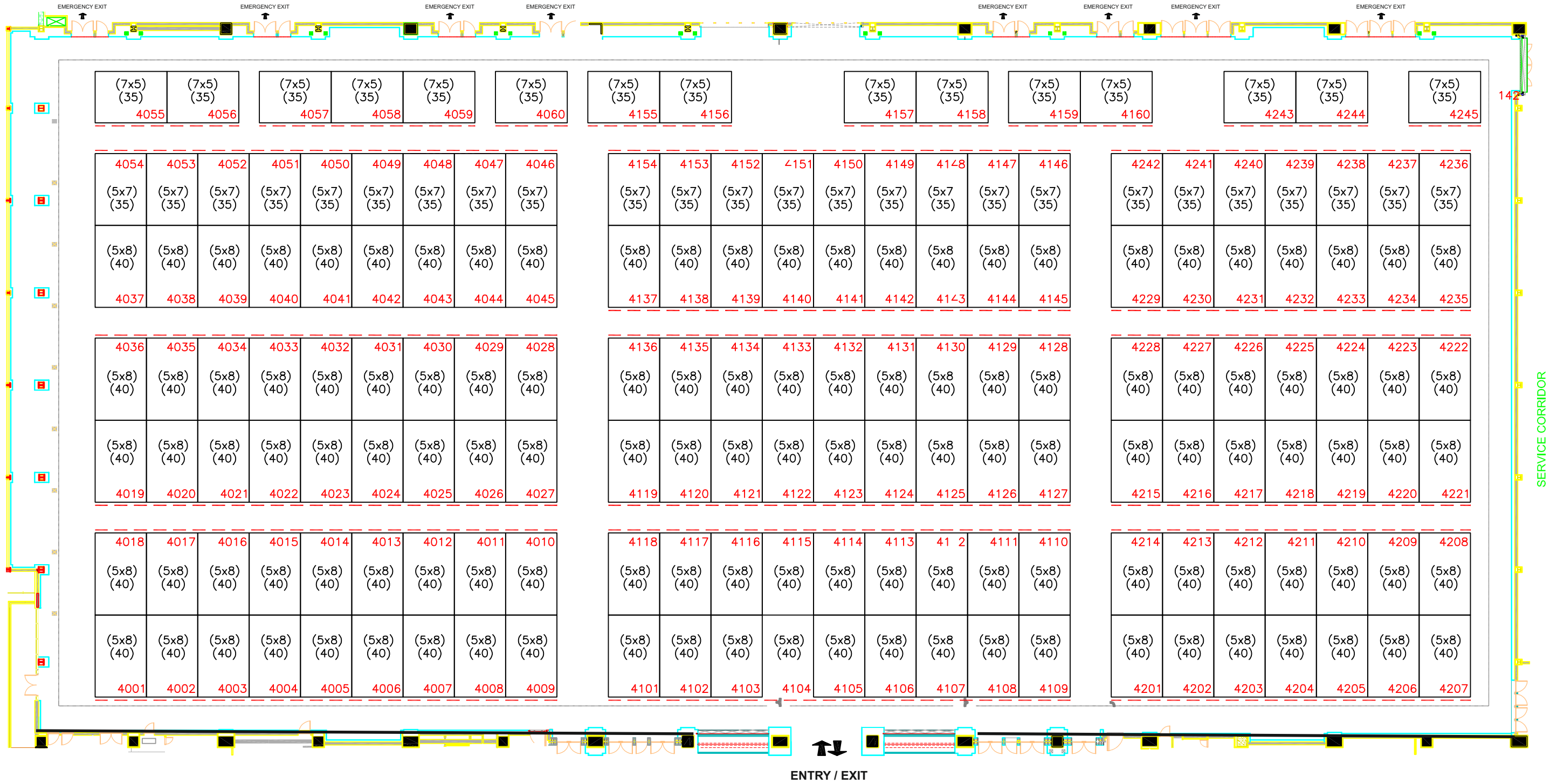

--- INDICATING OPEN SIDE OF STALL

Though due care has been taken in preparing the Floor Plan. CMAI reserves the right to alter, vary, enlarge, reduce the Floor Plan as may be required from time to time. However, abundant care would be exercised to ensure that the Participants are not in anyway inconvenienced.